



### S-377

- Forged carbon steel, Quenched & Tempered.
- The resultant load on each hook cannot exceed 1,000 lb.
- Meets the performance requirements of Federal Specification RR-C-271G, Type V, Class 6, except for those provisions required of the contractor.



### S-377 Barrel Hooks

Working Load Limit Per Pair (t)*	Stock No. Per Pair	Weight Each Per Pair (lb)	Dimensions (in)			
			I.D. of Eye	O.D. of Eye	Overall Length	Width of Lip
1.0	1028248	3.56	1.56	2.81	5.00	2.88

4:1 Design Factor.



### S-3316

- Easily attaches to any chain and electric hoist with welded link load chain, roller chain or wire rope with suitable end fitting.
- Swivel jaw is forged.
- Suitable for positioning before lifting.

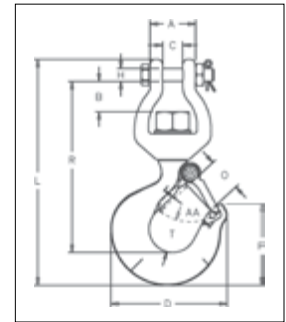

APPLICATION AND WARNING INFORMATION SECTION 17



### S-3316 Replacement Hook

Working Load Limit (t)*	Frame Code	Stock No.	Weight Each (lb)	Dimensions (in)										Replacement Latch Kit Stock No.
				A	B	C	D	H	L	O	P	R	T	
.45	F	1023029	1.25	1.32	.70	.56	3.15	.38	6.27	.96	2.22	4.74	.99	1096374
.91	H	1023047	2.61	1.57	1.00	.67	3.99	.44	7.77	1.16	2.78	5.89	1.16	1096468

5:1 Design Factor.



### A-378

- Forged alloy steel, Quenched & Tempered.
- Deep straight throat permits efficient handling of flat plates or large cylindrical shapes.



### A-378 with Handle

### A-378 Sorting Hook



Working Load Limit at tip of Hook (t)*	Working Load Limit at bottom of Hook (t)*	Stock No	Style	Weight Each (lb)	Dimensions (in)			
					I.D. of Eye	Overall Length	Opening at top of Hook	Radius at bottom of Hook
2	7-1/2	1028024	No Handle	6.42	1.38	9.69	2.81	.625
2	7-1/2	1028033	With Handle	6.42	1.38	9.69	2.81	.625

4:1 Design Factor.